

5023-A | AIR APPLIED CALIPER DISC BRAKE

KEY BENEFITS

Bronze & stainless steel construction

Easily changed brake pads

Well matched to Kobelt's standard range of 2" ventilated discs

Putting you in control.

For over three decades, Kobelt has been manufacturing air applied disc brakes using a double diaphragm design for accurate tension control. Constructed of bronze and stainless steel, Kobelt's disc brakes are built to last in the harshest conditions.

Available with several options, these caliper disc brakes are well suited for service braking applications on uncoilers, work boats and more .

SPECIFICATIONS

Normal Force:	0...7150 lbs	[31.8 KN]
Maximum Pressure:	100 psi	[6.9 bar]
Port Size:	¼ NPT	
Actuator Volume:	14.6 in ³	[240 cc]
Temperature Range:	-40°F...+120°F -40°C...+49°C	
Disc Thickness:	2 in	[51 mm]
Minimum Disc Diameter:	20 in	[508 mm]
Maximum Disc Diameter ² :	60 in	[1524 mm]
Pad Life:	1042 hp-hr	[777 kw-hr]
Weight:	61 lbs	[27.7 kg]

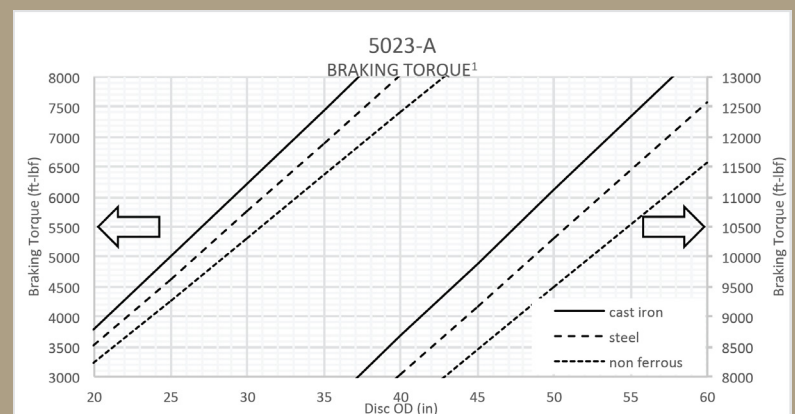

¹ Values in this chart are theoretical and for reference only. They are based on properly bedded and burnished linings acting on a rotor at 20°C and manufactured to required specifications.

² Requires a minimum 4.34 in [110 mm] wide face.

SPECIFICATIONS

FOOT MOUNTED VERSION

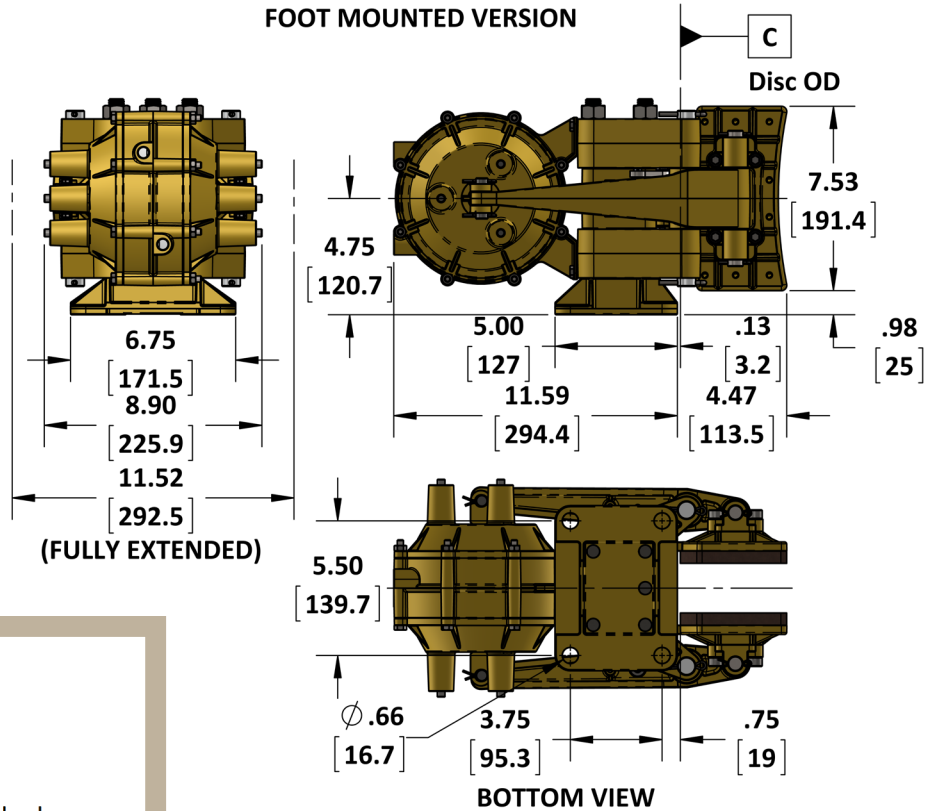

Brake Model Code Key

5023-A - -

Friction material
 (blank) = standard
 N = non-sparking
 C = low COF (.12-.15)
 E = mid COF (.25-.28)

Disc thickness
 (blank) = 2.000 in
 175 = 1.750 in
 150 = 1.500 in
 125 = 1.250 in
 100 = 1.000 in

Mounting code
 (blank) = foot mounted
 W = side mounted

SIDE MOUNTED VERSION

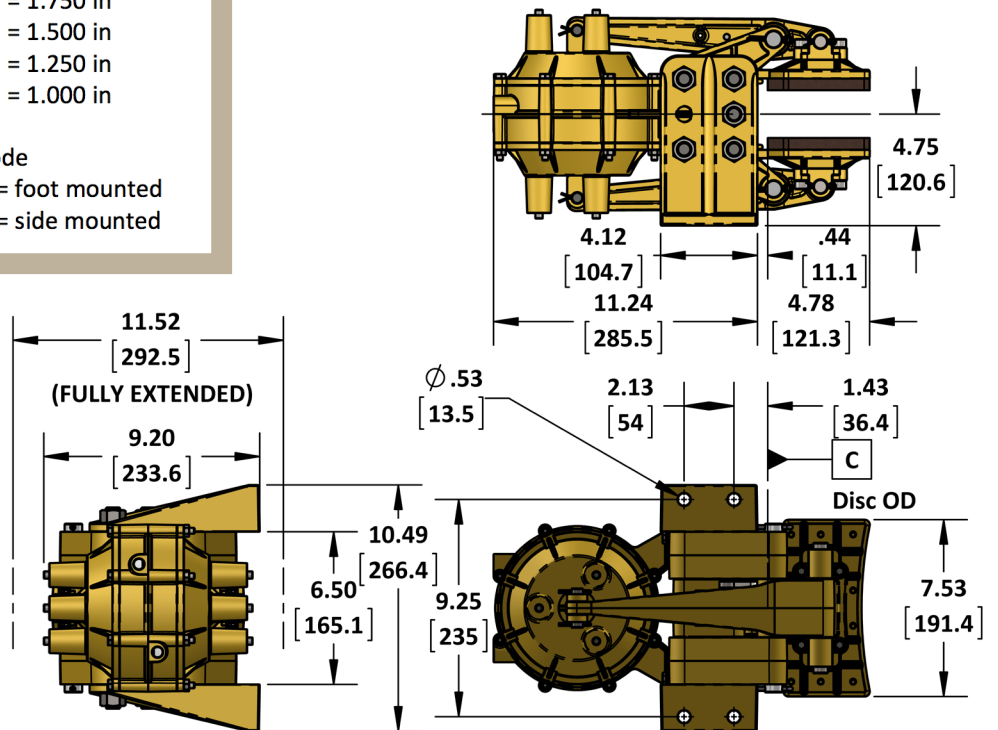

PARTS LISTING

5023-A Caliper Brake

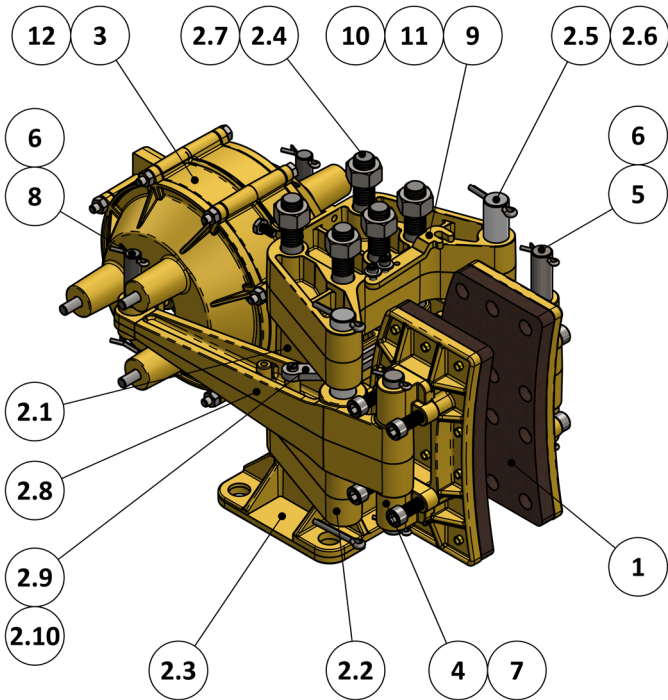

5023-AW Caliper Brake

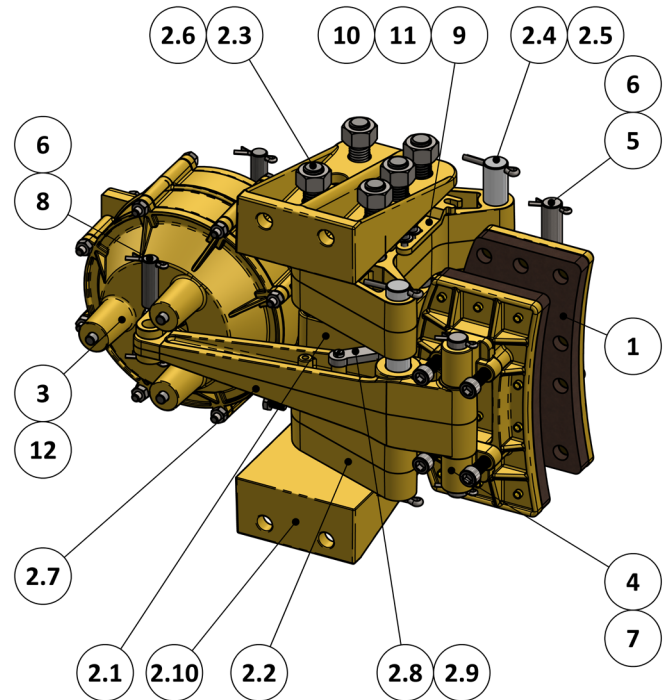

ITEM	QTY.	PART NUMBER	5023-A DESCRIPTION
1	2	5021-LS	SHOE ASSEMBLY, 5021 CALIPER, 1/2" K5
2	1	5023-SUB	SUB-ASSEMBLY, 5023 CALIPER
2.1	1	5021-0003	SPACER, 5021 CALIPER
2.2	2	5023-0002	SADDLE, 5023 CALIPER
2.3	1	5021-0001	FOOT, 5021 CALIPER
2.4	5	5021-0023	TIE ROD, 5/8-11NC
2.5	2	5021-0022	SADDLE PIN, 5021 CALIPER
2.6	4	1026-0824	COTTER PIN, 3/16 X 1 1/2
2.7	5	1022-0116	REG HEX NUT 5/8-11 NC, GR 18-8
2.8	2	5023-0004	LEVER, 5023 CALIPER
2.9	2	5021-0011	BALANCING LINK, PART 1, 5021 CALIPER
2.10	2	5021-0226	LINK PIN, 5/16NC X 7/8 LG
3	1	6120	AIR APPLIED ACTUATOR, 6120
4	4	5021-0006	PIVOT BLOCK, 5021 CALIPER
5	2	5021-0021	SHOE PIN, 5021 CALIPER
6	8	1026-0516	COTTER PIN, 1/8" X 1", SS
7	8	1002-1216	SCREW, SKT HD CAP, 3/8-16 UNC X 1, SS
8	2	6230-0010	CLEVIS PIN, 1/2" DIA
9	2	5021-0012	BALANCE LINK NO. 2, 5021 CALIPER
10	4	1023-0108	WASHER, FLAT, #10, TYPE A, SS
11	4	1002-0808	SCREW, SKT HD CAP, #10-24 UNC x 1/2 LG, SS
12	4	1001-1008	SCREW, HEX HD, 1/4-20 UNC X 1/2, SS

ITEM	QTY.	PART NUMBER	5023-AW DESCRIPTION
1	2	5021-LS	SHOE ASSEMBLY, 5021 CALIPER, 1/2" K5
2	1	5023-SUB-W	SIDE MOUNT SUB-ASSEMBLY, 5023 CALIPER
2.1	1	5021-0003	SPACER, 5021 CALIPER
2.2	2	5023-0002	SADDLE, 5023 CALIPER
2.3	5	5021-0023	TIE ROD, 5/8-11NC
2.4	2	5021-0022	SADDLE PIN, 5021 CALIPER
2.5	4	1026-0824	COTTER PIN, 3/16 X 1 1/2
2.6	10	1022-0116	REG HEX NUT 5/8-11 NC, GR 18-8
2.7	2	5023-0004	LEVER, 5023 CALIPER
2.8	2	5021-0011	BALANCING LINK, PART 1, 5021 CALIPER
2.9	2	5021-0226	LINK PIN, 5/16NC X 7/8 LG
2.10	2	5021-0101	SIDE MOUNT BRACKET, 5021 CALIPER
3	1	6120	AIR APPLIED ACTUATOR, 6120
4	4	5021-0006	PIVOT BLOCK, 5021 CALIPER
5	2	5021-0021	SHOE PIN, 5021 CALIPER
6	8	1026-0516	COTTER PIN, 1/8" X 1", SS
7	8	1002-1216	SCREW, SKT HD CAP, 3/8-16 UNC X 1, SS
8	2	6230-0010	CLEVIS PIN, 1/2" DIA
9	2	5021-0012	BALANCE LINK NO. 2, 5021 CALIPER
10	4	1023-0108	WASHER, FLAT, #10, TYPE A, SS
11	4	1002-0808	SCREW, SKT HD CAP, #10-24 UNC x 1/2 LG, SS
12	4	1001-1008	SCREW, HEX HD, 1/4-20 UNC X 1/2, SS

PARTS LISTING

6120 Actuator

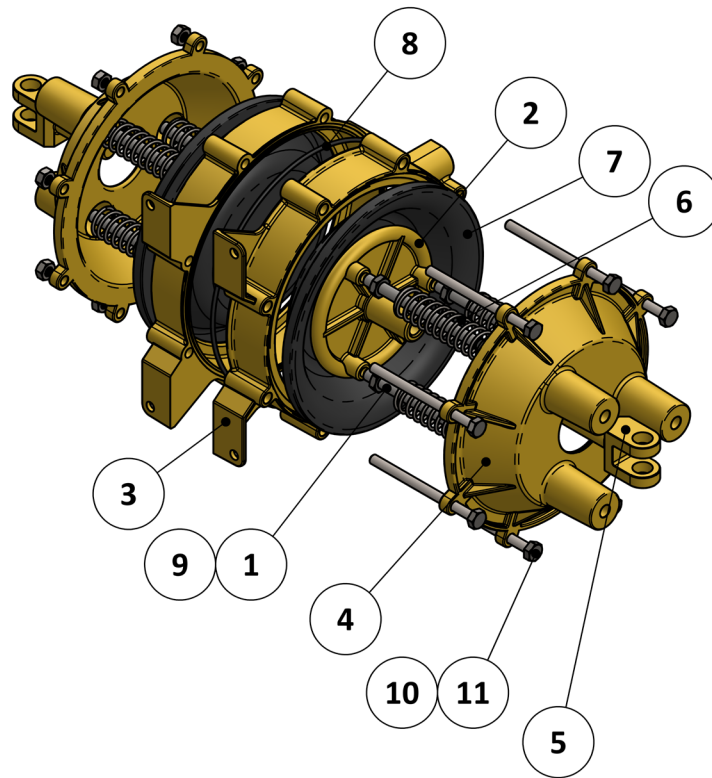

ITEM	QTY.	PART NUMBER	6120 DESCRIPTION
1	6	6120-0005	GUIDE PIN, 6120 ACTUATOR
2	2	6120-0004	DIAPHRAGM WASHER, 6120 ACTUATOR
3	2	6120-0003	CENTRE HOUSING, 6120 ACTUATOR
4	2	6120-0002	END CAP, 6120 ACTUATOR
5	2	6120-0001	CLEVIS, 6120 ACTUATOR
6	6	1201-0185	SPRING, COMPRESSION, .830 OD X .080 WIRE X 4.43 L
7	2	1105-0020	DIAPHRAGM, NO. 20 SIZE
8	1	1101-2166	O-RING, 6-3/4 ID X 3/32 THK, NBR70
9	6	1022-0211	NUT, JAM, 5/16"-18 UNC, SS
10	8	1022-0110	NUT, HEX, 1/4-20 UNC, SS
11	8	1001-1056	BOLT, HX HD, 1/4-20 UNC X 3.5", SS

Note: Parts lists are applicable to standard models only.